

# WXL Series Extraction Arm

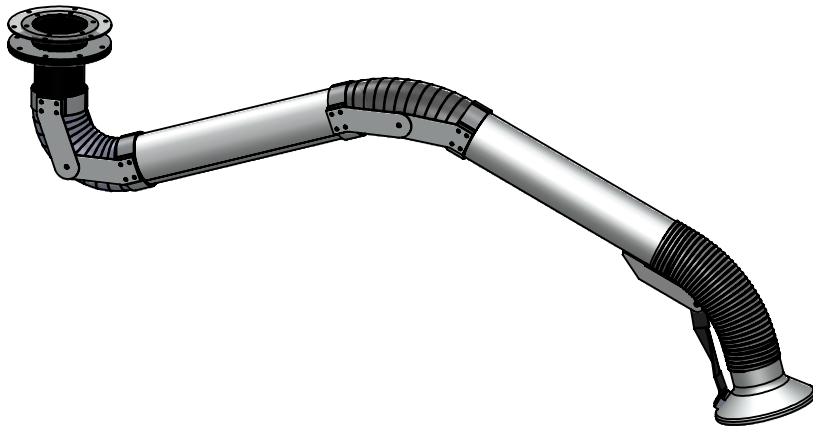

## Key Features

- Integral Bolt-up Flange Mounting With 360 deg Synthetic Lubrisc Bearing Assembly
- Self Supporting Tubular Aircraft Aluminum Construction With Tensioning Adjustments at Articulation Joints
- Omni-Directional Positioning Flex Section With Collection Hood
- WXL Available as an Inverted Table Mount or as a Hanging Mount (Please Review Design and Check Appropriate Box Below)

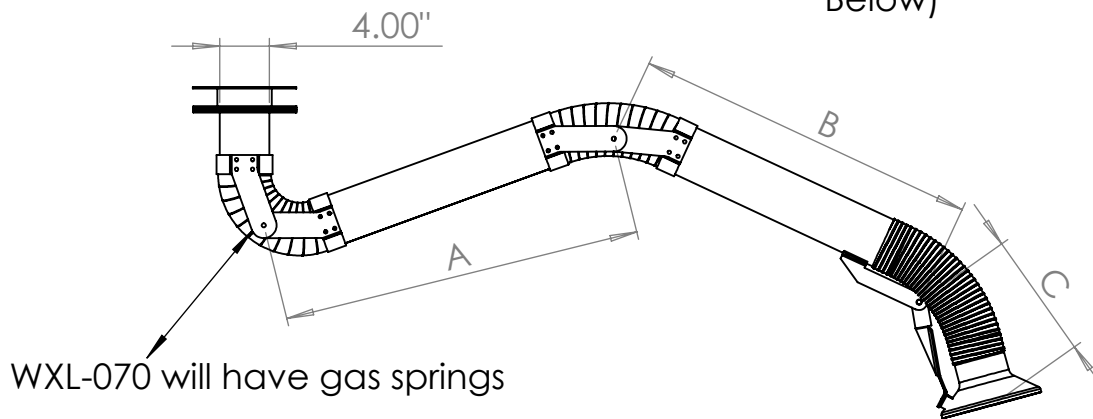

Quantity		Model	Platform		Dimensions			Mounting Orientation	
3"	4"		Wall	Ceiling	A	B	C	Inverted Mount	Hanging Mount
		WXL-030			12"	12"	12"		
		WXL-050			24"	18"	18"		
		WXL-070			34"	32"	18"		

Series WXL fume extraction positioning arm is constructed of tubular sections joined by unobstructed flex hose connections. The arm rotates on a bearing assembly comprised of a non-metallic, lubrisc synthetic material. Arms are designed for ceiling or wall mounting to provide source capture for fume removal applications. Available in standard diameters of 3" and 4". The WXL-030 capable of 3' extension, the WXL-050 capable of 5' horizontal extension, and the WXL-070 capable of 7' extension. All arms feature 180 degrees when wall mounted, 360 degrees rotation when ceiling mounted.